

>> LAY OUT / SPECIFICATION

Platform Length : 4,800mm

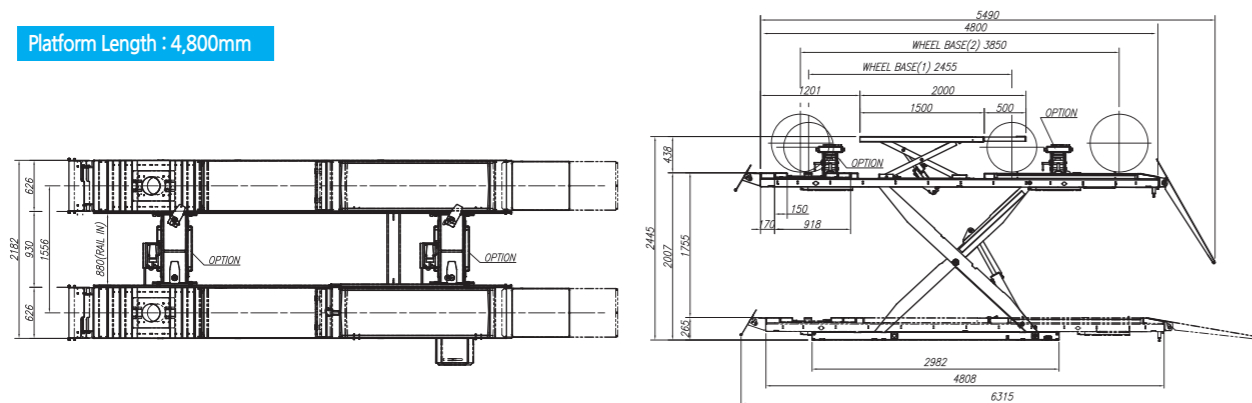

Model No.	HL-52N / Platform length: 4,800mm
Dimension	6,315(L) x 2,182(W) x 2,445(H) mm
Max. Height	Main : 2,007 mm / Aux: 438 mm
Min. Height	265 mm
Lifting Time	Main : 40~70 sec. / Aux: 10~20 sec.
Lowering Time	Main : 45~70 sec. / Aux: 10~30 sec.
Lifting Capacity	Main : 5,000 kg / Aux: 3,600kg
Power Supply	400V x 3ph x 50/60Hz
	230V x 3ph x 50/60Hz
Motor Power	2.2 kW(3hp) / 3kW(4hp)
Net Weight	3,250 kg

>> LAY OUT / SPECIFICATION

Platform Length : 5,200mm

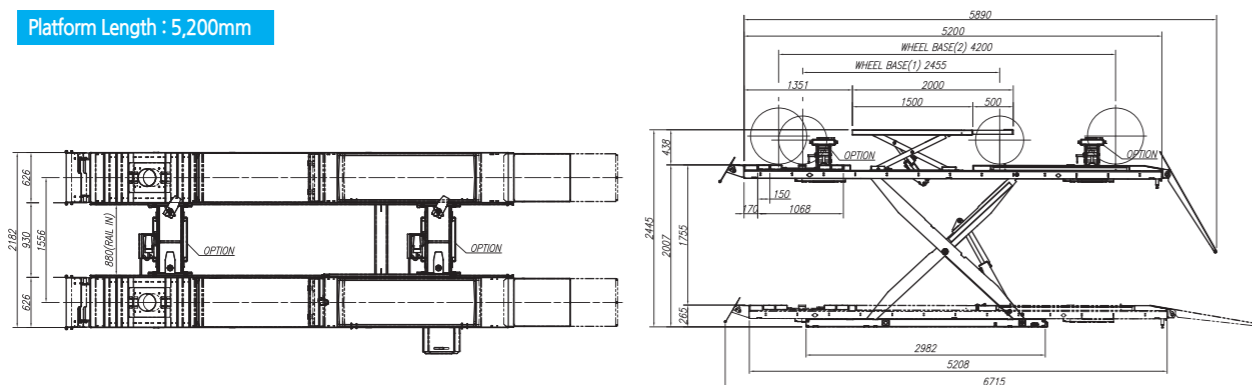

Model No.	HL-52N / Platform length: 5,200mm
Dimension	6,715(L) x 2,182(W) x 2,445(H) mm
Max. Height	Main : 2,007 mm / Aux: 438 mm
Min. Height	265 mm
Lifting Time	Main : 40~70 sec. / Aux: 10~20 sec.
Lowering Time	Main : 45~70 sec. / Aux: 10~30 sec.
Lifting Capacity	Main : 5,000 kg / Aux: 3,600kg
Power Supply	400V x 3ph x 50/60Hz
	230V x 3ph x 50/60Hz
Motor Power	2.2 kW(3hp) / 3kW(4hp)
Net Weight	3,350 kg

www.heshbon.com



WHEEL ALIGNMENT SCISSOR LIFT

HL-52N



HL-52N / 5TON

>> FEATURES

- High-Performed durable hydraulic cylinders composed by double pressure seals.
- Master & Slave cylinder synchronization system ensure the High-Performed synchronization.
- Air cylinder operated locking device.
- Easy synchronization control system by special hydraulic valves.
- Auxiliary lift table built in the platforms for wheel free operation.
- Auto-pneumatic rear slip plates locking device.
- Front turn-table recesses and rear sliding plates for 4-wheel alignment operation.
- Locking position sensor for stabilize platform level.
- Applicable to both in/above-ground mount.
- Descend alarm signal. (CE)
- Two step descending system gives full foot protection. (CE)
- Hydraulic hand-pump for emergency ascend/descend. (CE)
- De-synchronization detecting electronic photo-cell. (CE)
- Pit frame for in-ground type. (OPTION)
- Lighting kits 4pcs. (OPTION)
- Step board for worker's convenience. (OPTION)
- Ramp extensions for low chassis vehicle. (OPTION)

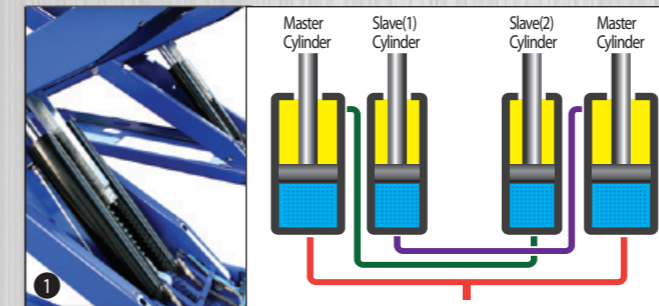

Master & Slave Hydraulic synchronization system



De-synchronization detecting electronic photo-cell.

Controls the synchronization of the 2 auxiliary lift platforms stops the function if the platforms are out of level.

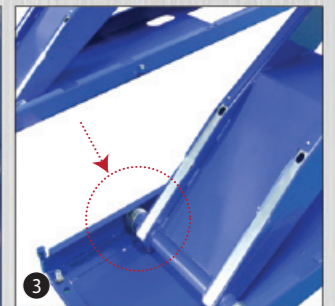

High performed roller

Oilless ball bearing in roller guaranty long durability and noise reduction.



Drive-on

Drive-on ramps ensure easy access ; when in lifted position they operate as wheel stopper.

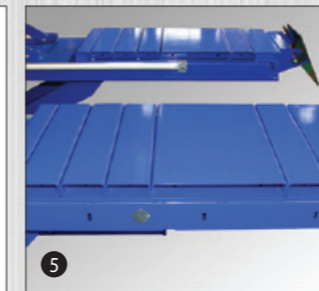

Lifts for wheel alignment

Lifts for wheel alignment with front recesses for turntables and rear slip plates.



Auxiliary lift table

Auxiliary lift table built in the platforms for wheel free operation.



Slide extension

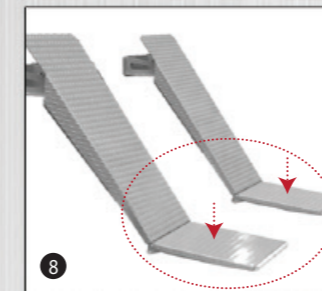

Ramp extensions (option)

Ramp extensions for low chassis vehicle.



Lighting kits 4pcs (option)

light kits to provide ultimate underbody lighting is available as an option.



Step board for worker's convenience (option)

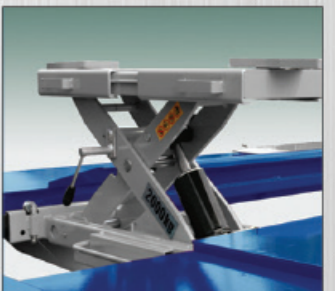

Rolling jack (option)

Built in rolling jack with adjustable extensions to optimise vehicle loading.

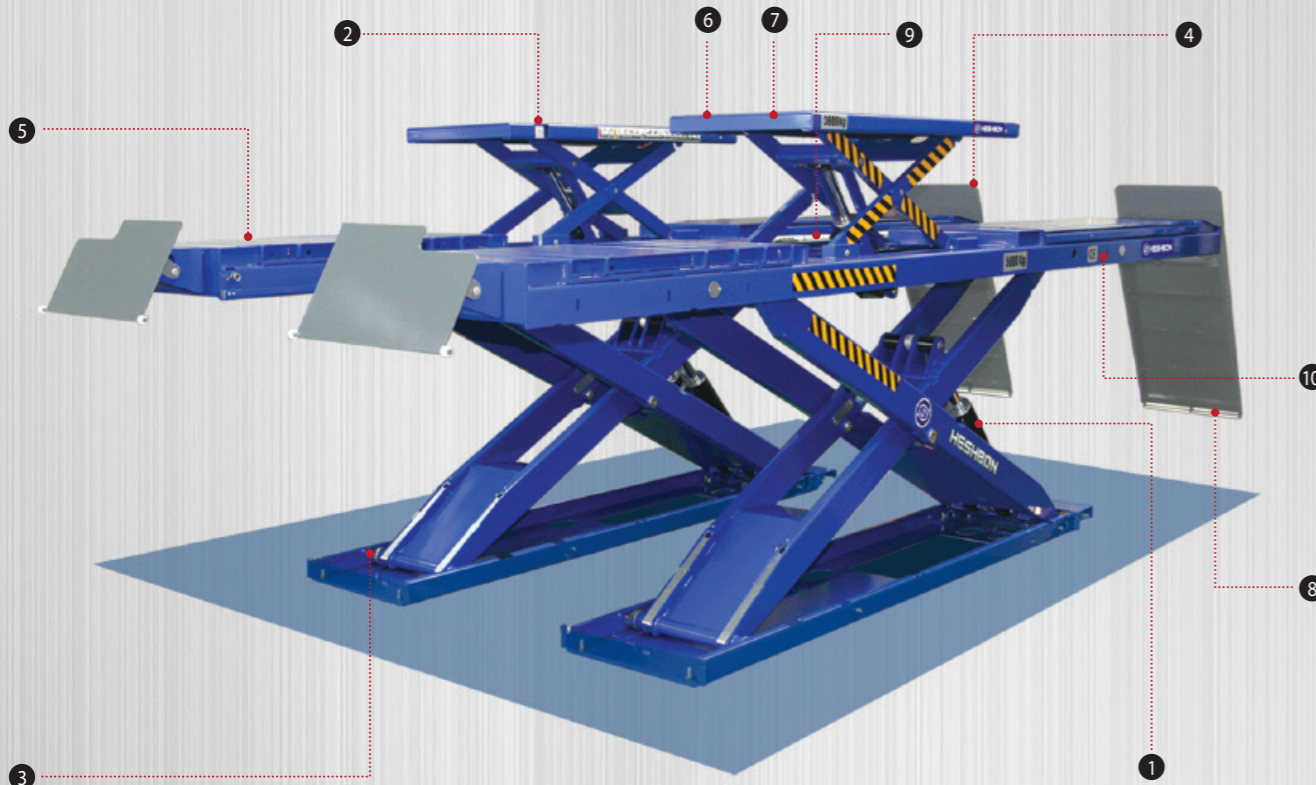

PASS THE HARSH TEST



**115% OVERLOAD
DYNAMIC TEST**



**150% OVERLOAD
STATIC TEST**

**15,000 CYCLES
DURABILITY TEST**



Control Box

The control console features an integrated hydraulic unit and thus considerably helps reduce the installation effort.

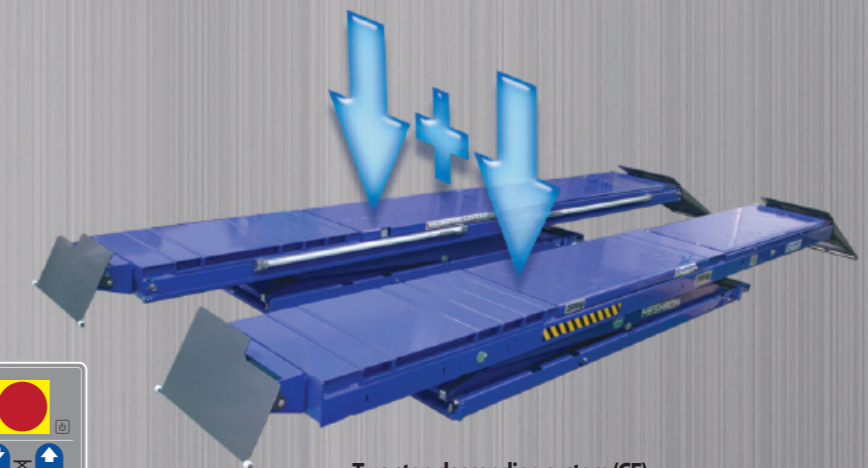

Two step descending system (CE)

It is equipped with an anticrushing safety device that locks the lift during descent at 150mm above the ground; lowering will not continue until a further command is given from the control panel. A beeper will then sound throughout the final lowering phase.